

Click on part numbers for product details or visit www.sonnax.com to see all products for the unit(s) shown here.

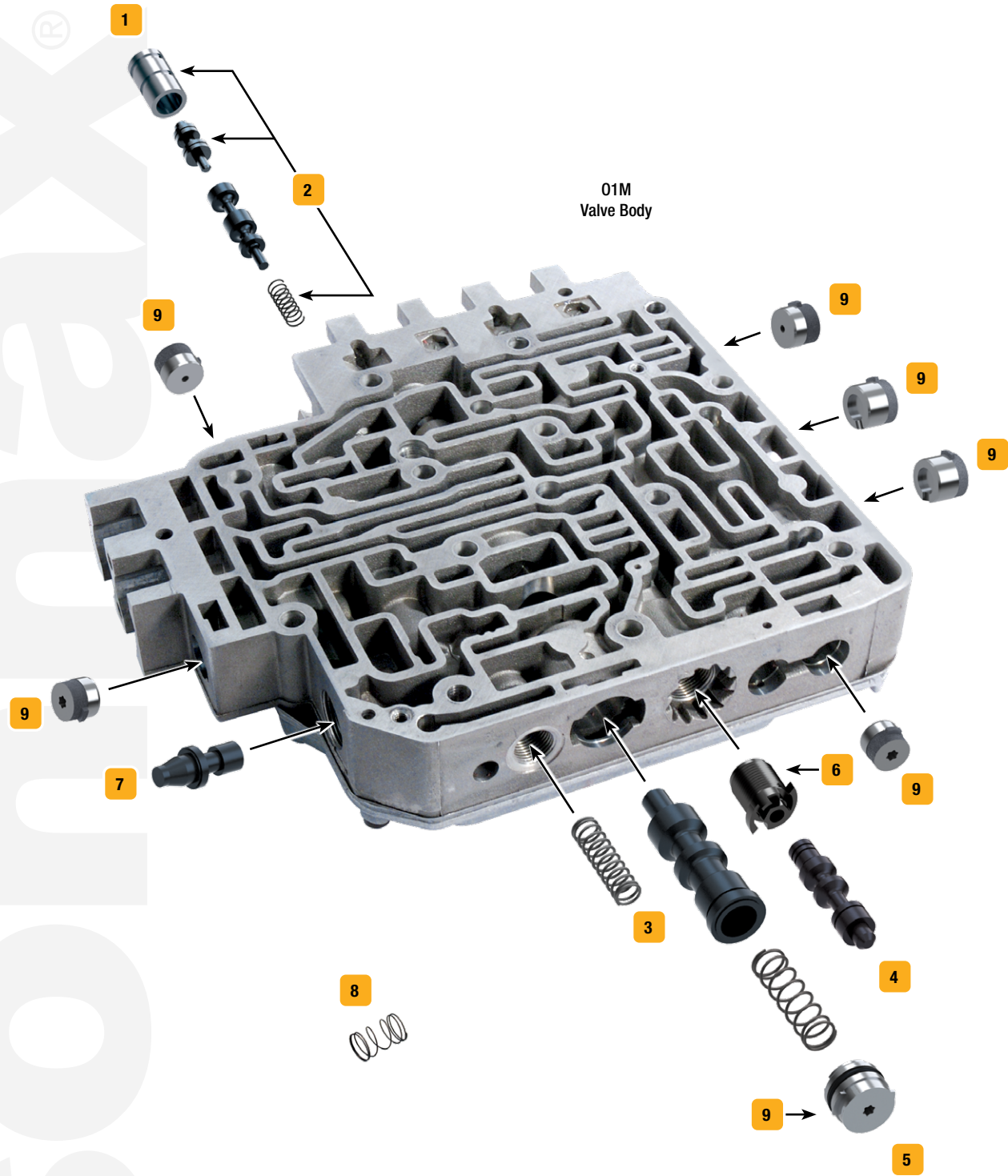

Symptoms/Benefits	Product Name	Part No.	Details	ZIP Drop-In Zip Valve™ Parts	Tooling
Multiple Symptoms					
Comprehensive kit for big problems you don't want back	The Sure Cure® Kit	SC-01M/01N/01P	01M, 01N, 01P only		F-119940-TL3*, 119940-TL4‡, F-119940-TL5*, F-119940-TL6*
TCC/Lockup Symptoms					
No lockup, Falls out of lockup, Code 1582, Engine stall on engagement	Oversized TCC Apply Valve Kit	1 119940-04K	01M, 01N, 01P only		119940-TL4‡, 119940-BST †
Engine stall on stop, Engine stall on N-D engagement, Overheated converter	TCC Boost Valve Kit	2 119940-01K	Z1P 01M, 01N, 01P only		
High TCC apply pressure, TCC slip codes, Converter hub & stator damage	TCC Regulator Valve Spring	3 119940-19	01M, 01N, 01P only, 5/bag		
Pressure Problems					
Harsh Reverse, Delayed engagement, Low pressure, Engine stall at idle, No line rise	Oversized Boost Regulator Valve Kit	4 119940-05K	01M, 01N, 01P only		F-119940-TL5*
Delayed engagement, Engine stall at idle, High line pressure in Reverse, No line rise	Oversized Main Pressure Regulator Valve Kit	5 119940-03K	01M, 01N, 01P only		F-119940-TL3*
Broken end plugs, Line pressure cannot be adjusted	Ratcheting End Plug	6 119940-22	Z1P		119940-TL9 †‡
2-3 Late, No 3-4, Wrong gear starts, No line rise, No 2-3, 3-4 Late, 2-3 Bind-up, Loss of gear	Oversized Solenoid Regulator Valve	7 119940-06K			F-119940-TL6*
Shift/Engagement Concerns					
2-3 Concerns, 3-2 Concerns, Soft shifts, Erratic buzz, Uncontrolled pressure in Reverse	Checkball Springs	8 119940-20	01M, 01N, 01P phase 2 only, 10/bag		
Broken end plugs, No shift, Uncontrolled shifts	Shift Cup Kit	9 119940K	Z1P 01M, 01N, 01P only		

* VB-FIX Required

† Recommended Tool

‡ No longer in production. Check with your distributor for availability.